

Find your own sky,
Let your dreams fly...

LEELA JANAK

A P A R T M E N T

Beautiful 2 & 3 BHK Flats





Kanaklaxmi
Developers

Nothing to hide
Transparent deals, always !

For over 12 years, Kanaklaxmi Developers has earned a reputation by building contemporary homes that are thoughtfully designed, meticulously executed and nestled in prime locations.

Building our foundation on the simple principles of professional integrity, transparency and uncompromising insistence on quality has paid rich dividends, and earned us the goodwill and trust of our patrons.

LEELA JANAK

APARTMENT

Leela Janak Apartment is a luxurious residential project by Kanaklaxmi Developers located near Dhattrak Phata, nestled in the developing residential area in Nashik. Apartments are meticulously crafted to offer ample space and comfort for the contemporary living. Leela Janak apartments are designed to provide you with numerous state-of-the-art amenities to lead an active lifestyle

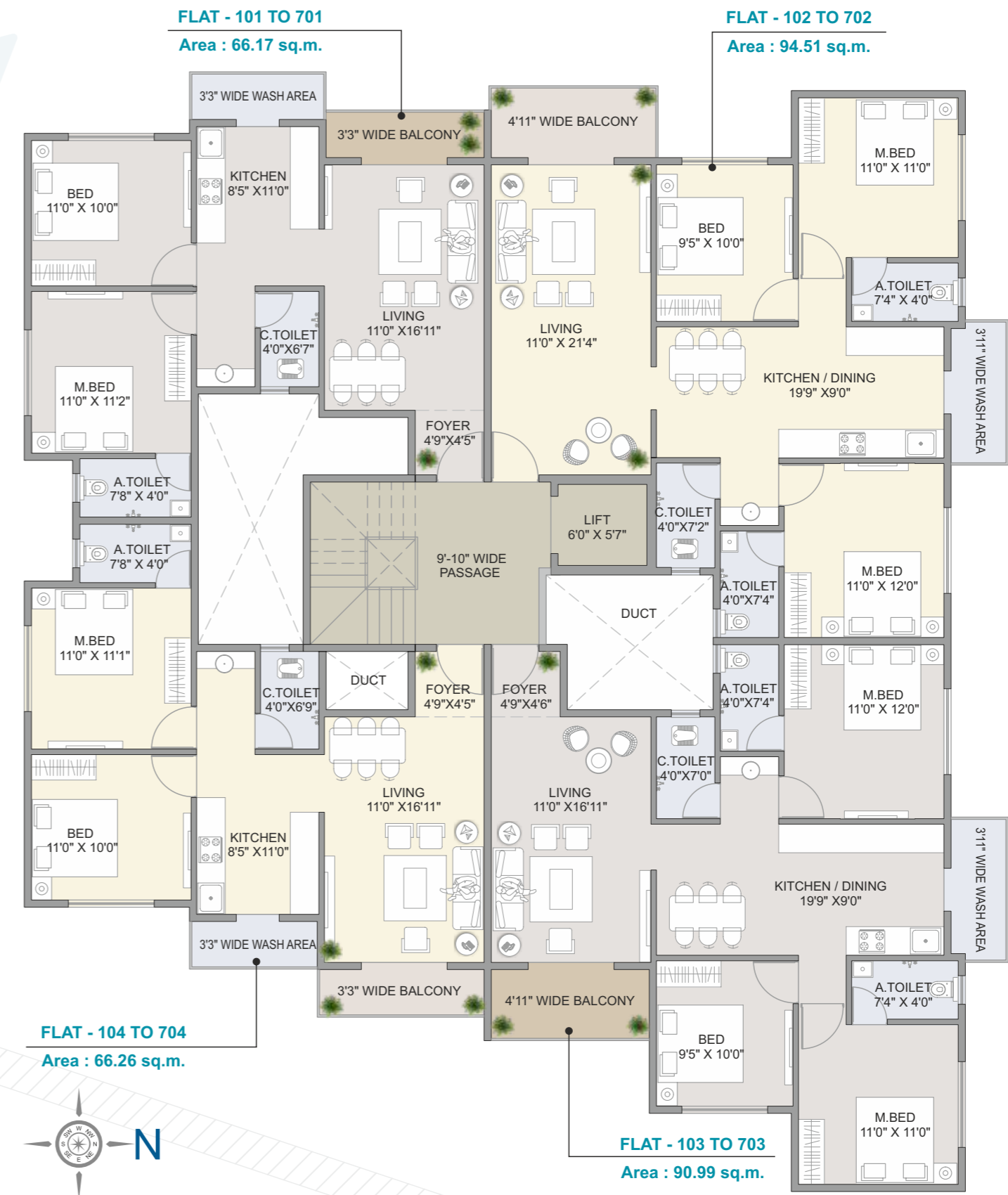
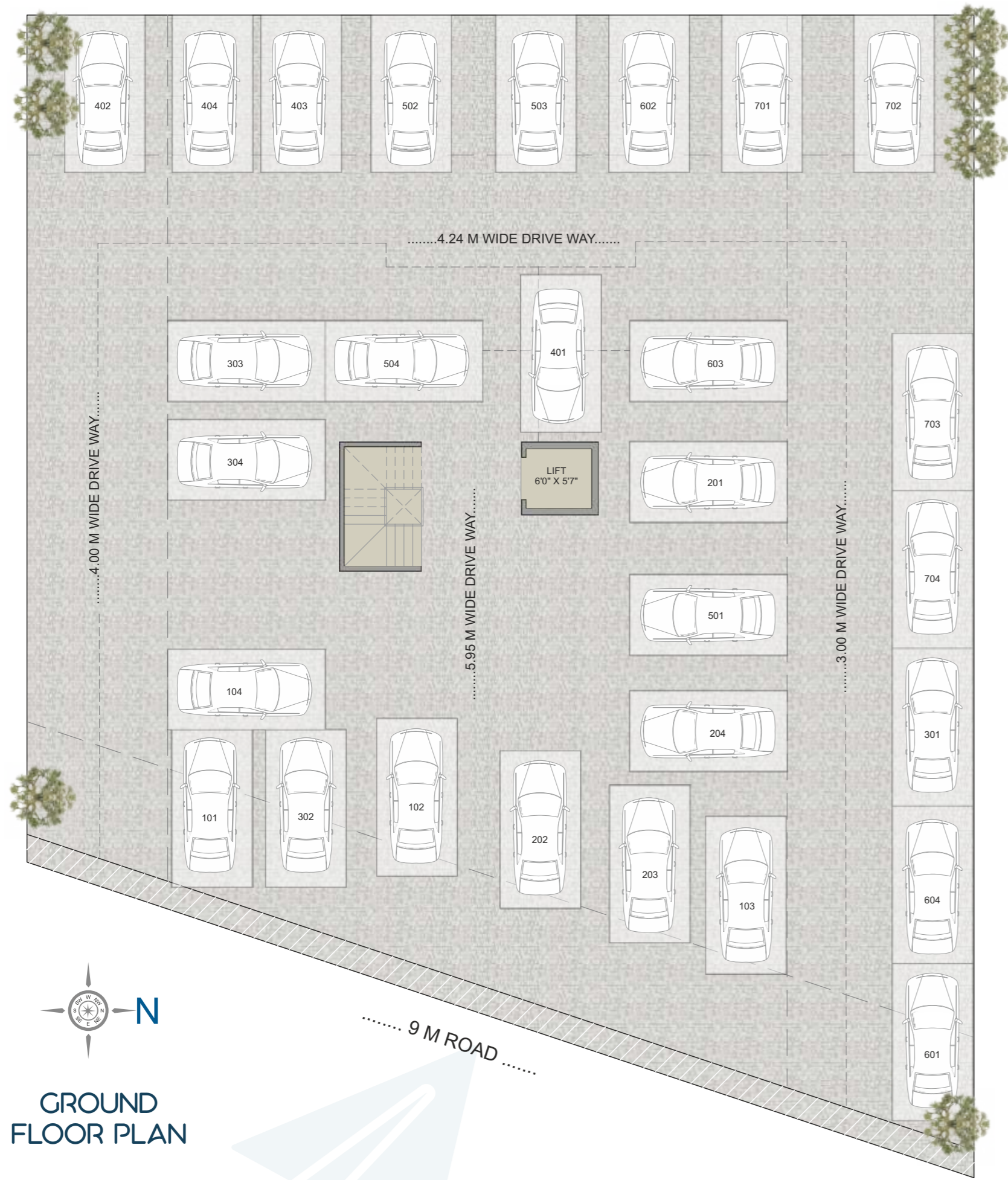



SPECIAL FEATURES

- ◆ Vaastu Compliant Plan
- ◆ EV Charging
- ◆ Allotted Parking
- ◆ CCTV & Solar Metering for Common Area
- ◆ Spacious Rooms



R.C.C.

- ◆ All R.C.C. work will be done with ISI grade cement and TMT - 500 Steel.
- ◆ Frame Analysis for "Earthquake Resistant Structure" done while designing the building.



Brick Work

- ◆ External walls will be 6" thick in brick masonry.
- ◆ Internal walls will be 4" thick with R.C.C. Patli for strengthening.



Doors

- ◆ All door frames will be of plywood with both side laminates. Steel grey frames in Bathrooms.
- ◆ Moulded flush door.



Windows

- ◆ 3 track Anodised aluminium sliding windows with S. S. Mosquito Net.
- ◆ M. S. Safety grill with 12 mm round bright bars.
- ◆ Window frames will be in Steel Grey Granite.



Bathroom

- ◆ All plumbing work will be concealed type.
- ◆ A branded hot & cold-water diverter shall be provided in bathroom.
- ◆ Provision for geyser shall be done in bathroom.
- ◆ All taps will be branded of standard companies .



Flooring

- ◆ All rooms flooring will be 800 mm x 800 mm branded vitrified tiles.
- ◆ Bathroom flooring will be anti-skid tiles of 12" x 12".
- ◆ Glazed tiles upto Lintel level will be provided for bathroom & toilet of size 24" x 12".



Plaster

- ◆ External plaster double coat in rich cement mortar.
- ◆ Internal plaster in rich cement mortar with Gypsum finish.



AMENITIES

Internal as well as External



Kitchen

- ◆ 8' granite kitchen otta with stainless steel shall be provided.
- ◆ Glazed tiles of size 12" x 18" upto Lintel Level will be provided in kitchen.



Paint

- ◆ External paint will be Apex, fungus resistant paint.
- ◆ Internal paint will be emulsion.
- ◆ Windows grill and railing will be oil paint.
- ◆ All paints will be in 2 coats lambi I putty and primer.



Parking

- ◆ Allotted Car parking.
- ◆ Parking will be provided with 50 mm thick paver block chequered tiles.
- ◆ Electric charging point for electric vehicle in parking.



Electrical

- ◆ Concealed electrification with telephone and cable point in hall.
- ◆ Excellent quality wiring will be provided! with branded switches.
- ◆ Branded lift with power backup system.



Miscellaneous

- ◆ Compound Wall and M. S. Gate will be provided for security.
- ◆ Brick bat coba for water proofing and heat control shall be provided on terrace with IPS Cement Flooring .
- ◆ Ample overhead and underground storage tank for water shall be provided for tlhe building.





Maha Rera No.
P51600053588



Member of
CREDAI
NASHIK METRO

ADDRESS : S. NO 561/1/A/PLOT NO 14+15,
DHATRAK PHATA , SAGAR VILLAGE,
ADGOAN SHIVAR , NASIK 422007

NEAR BY

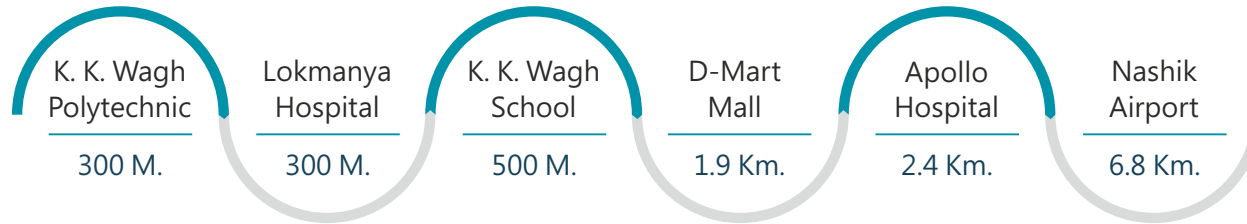

Kanaklaxmi Developers

303, "Hari Prabha Solitario", 3rd Floor, Thatte Nagar,
Off College Road, Nasik - 5. Office : 9922524762

Call : 9822111935, 9823405995

Website : www.kanaklaxmidevelopers.com



Ar kapil thakkar

Legal Advisor
Ad Mohan Baxi

Structural Consultant
Er Jayesh Makwana

Land owner
Surendra Kumar Sinha

Sanjay Choudhari

Note : The Developers reserve the right to change plans, specifications and features without prior notice or obligation, at their sole discretion and subject to approval of Government authorities. Specifications, writeup, internal layouts, plans and pictures shown in this booklet are only indicative. All renderings, floor plans, pictures and maps are the artist's conceptions and not actual depictions of the building, its walls, roadways or landscaping.